

M5 Junction 10 Improvements Scheme

**Additional information relating to
Examining Authority's Question Q1.0.1**

TR010063 - APP 9.61

Rule 8 (1) (b)

Planning Act 2008

Infrastructure Planning (Examination Procedure) Rules 2010

Volume 9
July 2024

Infrastructure Planning Planning Act 2008

The Infrastructure Planning (Examination Procedure) Rules 2010

M5 Junction 10 Improvements Scheme Development Consent Order 202[x]

Additional Information relating to ExA Question Q1.0.1

Rule Number:	Rule 8 (1) (b)
Planning Inspectorate Scheme Reference	TR010063
Application Document Reference	TR010063/APP/9.61
Author:	M5 Junction 10 Improvements Scheme Project Team

Version	Date	Status of Version
Rev 0	July 2024	Deadline 3

DO NOT SCALE
 0 10 100
 Millimetres

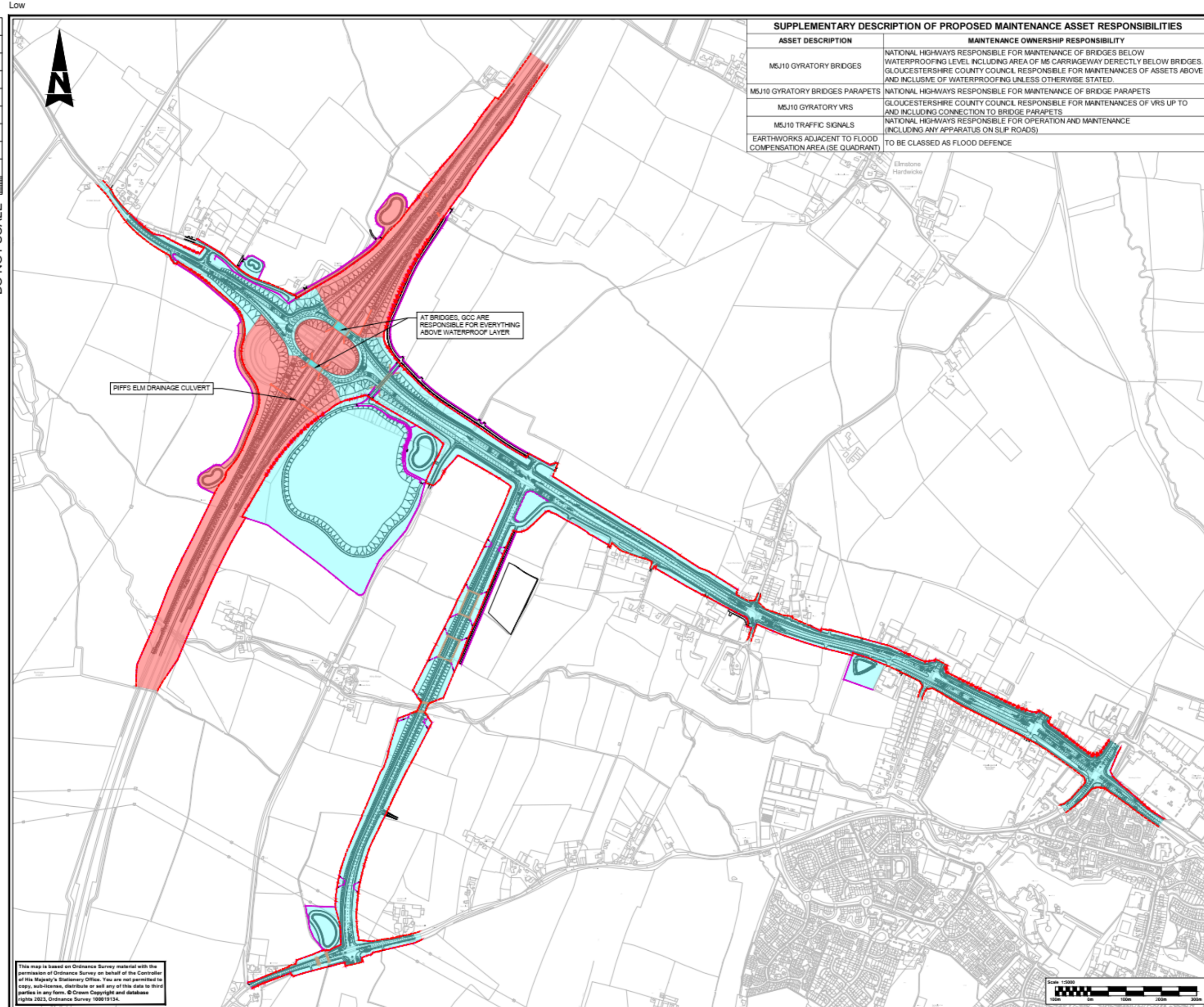

SUPPLEMENTARY DESCRIPTION OF PROPOSED MAINTENANCE ASSET RESPONSIBILITIES	
ASSET DESCRIPTION	MAINTENANCE OWNERSHIP RESPONSIBILITY
M5J10 GYRATORY BRIDGES	NATIONAL HIGHWAYS RESPONSIBLE FOR MAINTENANCE OF BRIDGES BELOW WATERPROOFING LEVEL INCLUDING AREA OF M5 CARRIAGEWAY DIRECTLY BELOW BRIDGES. GLOUCESTERSHIRE COUNTY COUNCIL RESPONSIBLE FOR MAINTENANCES OF ASSETS ABOVE AND INCLUSIVE OF WATERPROOFING UNLESS OTHERWISE STATED.
M5J10 GYRATORY BRIDGES PARAPETS	NATIONAL HIGHWAYS RESPONSIBLE FOR MAINTENANCE OF BRIDGE PARAPETS
M5J10 GYRATORY VRS	GLOUCESTERSHIRE COUNTY COUNCIL RESPONSIBLE FOR MAINTENANCES OF VRS UP TO AND INCLUDING CONNECTION TO BRIDGE PARAPETS
M5J10 TRAFFIC SIGNALS	NATIONAL HIGHWAYS RESPONSIBLE FOR OPERATION AND MAINTENANCE (INCLUDING ANY APPARATUS ON SLIP ROADS)
EARTHWORKS ADJACENT TO FLOOD COMPENSATION AREA (SE QUADRANT)	TO BE CLASSED AS FLOOD DEFENCE

NOTES

1. ALL DIMENSIONS ARE IN METRES UNLESS OTHERWISE STATED.

KEY:

- PROPOSED HIGHWAY EXTENT
- PROPOSED HIGHWAY FENCE LINE
- NATIONAL HIGHWAYS - MAINTENANCE AREA
- GCC - MAINTENANCE AREA

PIFFS ELM DRAINAGE CULVERT

AT BRIDGES, GCC ARE RESPONSIBLE FOR EVERYTHING ABOVE WATERPROOF LAYER

Description	Status	Revision	Drawn	Checked	Reviewed	Authorised	Issue Date
DF2 DESIGN	A1	C01	NG	NKRP	CCR	TT	29/09/21
DESIGN FIX 3	A1	C02	MC	CJ	AM	TT	07/07/22
DESIGN FIX 3 - FINAL	A1	C03	MC	CJ	CCR	BM	27/02/23
Bus Lane Update	A1	C04	MC	NKRP	CCR	BM	14/06/23

Drawing Status: APPROVED - PUBLISHED

Status: A1

ATKINS
 5th Floor, Block 5
 Shire Hall
 Bearland
 Gloucester
 GL1 2TH
 Tel: 08000 514514

Copyright © Atkins Limited (2022)

Gloucestershire
 COUNTY COUNCIL

Project Title: M5 Junction 10 Improvements Scheme

Drawing Title: M5 JUNCTION 10 MAINTENANCE AREAS

Drawing Number: GCCM5J10 - ATK - HGN - ZZ - DR - CH - 000121

Project Ref. No: 5197035

Scale: 1:5000

Sheet: 1 of 1

Rev: C04

This map is based on Ordnance Survey material with the permission of Ordnance Survey on behalf of the Controller of His Majesty's Stationary Office. You are not permitted to copy, sub-license, distribute or sell any of this data to third parties in any form. © Crown Copyright and database rights 2023, Ordnance Survey 100019134.

AtkinsRéalis

5th Floor, Block 5
Shire Hall
Bearland
Gloucester
GL1 2TH

Tel: +44 (0) 8000 514 514